

CHAMELEON (100 MICRON)



C01
Blue



C02
Orange



C03
Pink



C04
Green



C05
Red



C06
Violet

MOSAIC FILM (500 MICRON)



M01
Silver



M02
Gold



M10
Black



M11
Dark Grey



M13
Brown



M14
S / Silver

PEARL SILICONE (250 - 280 MICRON)



WDSR
White



WDSR
Black



WDSR
Silver



WDSR
Gold

CHAMELEON / MOSAIC FILM / PEARL SILICONE / FOAM

DESCRIPTION

CHAMELEON - Laser and plotter cutting
LENTICULAR - Only for laser cutting
PEARL SILICONE - Laser and plotter cutting

SPECIFICATION

CHAMELEON Size: 50 cm x 100 m
N.W: 14,5 kg / roll

PEARL SILICONE Size: 50 cm x 50 m
N.W: 14,5 kg / roll

MOSAIC FILM Size: 27 cm x 45 m
N.W: 8 kg / roll

ÜRÜN TANIMI

CHAMELEON - Lazer ve plotter kesim
MOSAIC FILM - Sadece lazer kesim
PEARL SILICONE - Lazer ve plotter kesim

ÖZELLİKLER

CHAMELEON Ebat: 50 cm x 100 m
Net Ağırlık: 14,5 kg / roll

PEARL SILICONE Ebat: 50 cm x 50 m
Net Ağırlık: 14,5 kg / roll

MOSAIC FILM Ebat: 27 cm x 45 m
Net Ağırlık: 8 kg / roll

TRANSFER CONDITION

The following instructions are given as guideline only.
CHAMELEON Temp: 160°C (320°F) - Pres: 10 seconds
MOSAIC FILM Temp: 160°C (320°F) - Pres: 12 seconds
Backside Press: 185°C (365°F) - Pres: 5 seconds
PEARL SILICONE Temp: 150°C - 160°C (302°F - 320°F)
Pres: 10 seconds

BASKI TALİMATLARI

Aşağıdaki talimatlar sadece normal şartlara göre.
CHAMELEON Derece: 160°C (320°F) - Pres: 10 saniye
MOSAIC FILM Derece: 160°C (320°F) - Pres: 12 saniye
Tersten Presleme: 185°C (365°F) - Pres: 5 saniye
PEARL SILICONE Derece: 150°C - 160°C (302°F - 320°F)
Baskı Süresi: 10 saniye

SUITABLE FOR

Cotton, mixtures of polyester / cotton and polyester / acrylic
or for similar textile.
Not suitable for treated and dyed garments.

UYGUN KUMAŞLAR

Pamuk, polyester / pamuk karışımı, polyester / akrilik vb
tekstiller için uygundur.
Boyanmış ve işlem görmüş kumaşlar için uygun değildir.

NOTICE

We offer you to test the product against the color migration.
Pressing instruction may change, according to the fabric
type.

UYARI

Boyalı kumaşlarda migrasyon ihtimaline karşı üretim öncesi
gerekli testlerin yapılmasını öneririz. Kullanılacak kumaşın
içeriğine göre, basım talimatları değişebilir.



Cut the image in reverse
Deseni tersten kesiniz

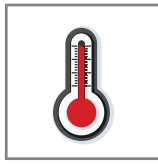

CHAMELEON
160°C (320°F)
MOSAIC FILM
Normal Press: 160°C (320°F)
Backside Fabric: 185°C (365°F)
PEARL SILICONE
150°C-160°C (302°F-320°F)



4 Bar pressure
4 Bar basınç



CHAMELEON - FOAM
15 seconds for pressing
15 saniye presleme
MOSAIC FILM
12 seconds for pressing
12 saniye presleme
PEARL SILICONE
10 seconds for pressing
10 saniye presleme

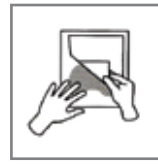

COOL Peel
Soğuk çekim

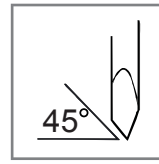

45°



After 24H with application
Uygulamadan 24 saat sonra

Mehmet Nesih Özmen Mah. Savur Sk. No: 22 Merter - Güngören / İSTANBUL

Tel: 0 212 637 37 10 Faks: 0 212 637 37 80

www.trutape.com.tr

f t i y i n /trutape